



Dense Wavelength Division Multiplexers Module (4/8/16 Channels) (DWDM Series)

Rev 11

Description

The multi-channel Dense Wavelength Division Multiplexer Module is based on thin film DWDM devices by cascading individual channels into sequence. Channel numbers can be as high as 40 (16) for 100 (200) GHz systems in C band or in L band. They are featured with wide passband, low insertion loss, high channel isolation and high environmental stability. They can be used in dense WDM systems to perform multiplexing or demultiplexing functions.

Key Features

- Low Insertion Loss
- High Channel Isolation

Applications

- Denser Channel Plans

Specifications

Parameter	Unit	Value					
		4 Ch.	8 Ch.	16 Ch.	4 Ch.	8 Ch.	16 Ch.
Channel	-	4 Ch.	8 Ch.	16 Ch.	4 Ch.	8 Ch.	16 Ch.
Filter Type	nm		100 GHz			200 GHz	
Pass Bandwidth @ 0.5 dB	nm		0.22			0.5	
Max. Insertion Loss	dB	2.5	3.5	4.8	2.2	3.3	4.6
Passband Flatness	dB				1.0		
Channel Uniformity	dB				1.5		
Channel Isolation (Mux)	dB				N/A		
Channel Isolation (Demux)	dB				25		
Max. Polarization Dependent Loss	dB				0.1		
Max. Polarization Mode Dispersion	ps				0.1		
Directivity	dB				55		
Min. Return Loss	dB				45		
Center Wavelength Stability	nm/°C				0.002		
Thermal Stability	dB/°C				0.006		
Max. Optical Power	mW				300		
Tensile Load	N				5		
Fiber Type	-				SMF-28 Fiber		
Operating Temperature	°C				- 5 to + 70		
Storage Temperature	°C				- 40 to + 85		
Package Dimensions	mm	100 × 80 × 9.5 (4 Ch.), 133 × 95 × 9.5 (8 Ch.), 150 × 115 × 14 (16 Ch.)					

¹IL is 0.3 dB higher, RL is 5 dB lower for each connector added.

Package Dimensions

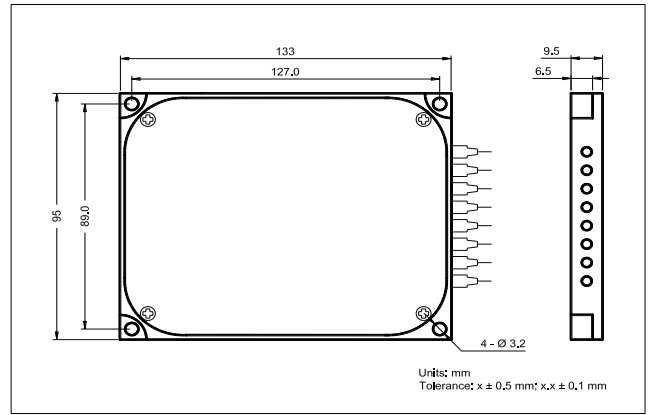
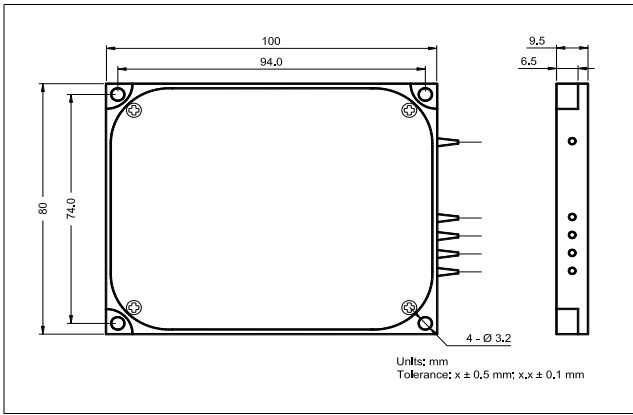

Ordering Information

DWDMM-①-②②-③-④④-⑤-⑥-⑦

①: Module Type

M - MUX

D - DEMUX

②②: Number of Channels

04 - 4 Channels

08 - 8 Channels

16 - 16 Channels

③: Channel Spacing

1 - 100 GHz

2 - 200 GHz

④④: First ITU Grid

⑤: Connector Type

1 - FC/UPC

2 - FC/APC

3 - SC/UPC

4 - SC/APC

N - None

S - Specify

⑥: Fiber Jacket

B - 250 μm Bare Fiber

L - 900 μm Loose Tube

C - 3 mm Cable

S - Specify

⑦: Fiber Length

H - 0.5 m

S - Specify